

## FTF-30-RD Centrifugal Feeder

*Designed for Quiet, High Speed Feeding*



### Product Overview:

Shibuya Hoppmann's standard FTF-30 rigid disc centrifugal feeder is designed to feed a variety of products in a food-grade environment with its unique bowl design. Product is metered into the bowl and brought out to the bowl rim where a series of qualifiers gently orient the part for transfer to various downstream inline devices.

### Product Specifications:

	<u>ANSI</u>	<u>Metric</u>
A. Outside Diameter	40.21"	1021mm
B. Frame Height	22.79"	579mm
C. Discharge Height	17.51"	445mm
D. Bowl Outside Diameter	36.13"	918mm
E. Bowl Inside Diameter	28.79"	731mm
F. Rim Width	3.67"	93mm
G. Bowl Depth	5.65"	144mm
H. Level Foot Adjustment	3.97" ± 1"	101mm ± 25mm

### Standard Models:

	<u>FT301RLDFA</u>	<u>FT301RLAFA</u>
Part Number	DC	AC
Motor Style	1/3 hp	1/3 hp
Horsepower	90V	230/460V
Motor Voltage		

### Required Accessories:

	<u>CW</u>	<u>CCW</u>
Square Frame		
Backup Ring .....	BUCWFT30FU	BUCCFT30FU

### Standard Features:

- All stainless steel construction
- Square tooling frame
- FDA approved ABS vacuum formed disc
- Teflon hard-coated finished aluminium bowl
- Washdown motors and drive assembly

### Standard Options:

- Polycarbonate covers
- Dual motor drive system

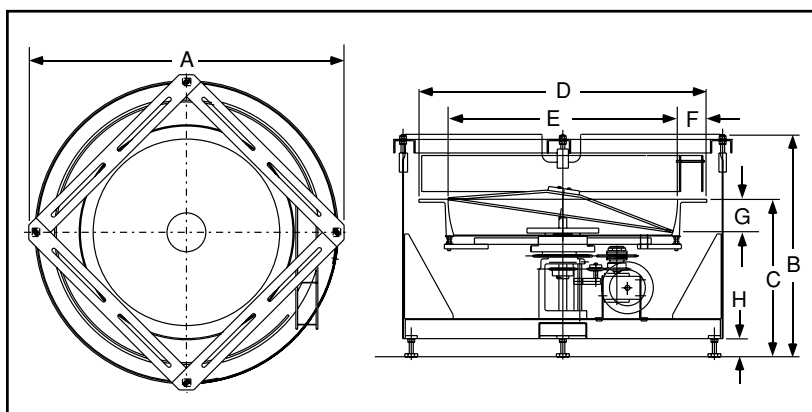

Shibuya Hoppmann Corporation strives to improve its products and reserves the right to change or discontinue specifications & designs shown in this brochure without notice and without incurring obligation. 01/07